

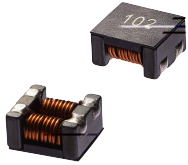

SMD Common Mode Inductor Size 1211



- Chip common mode filter for large current applications.
 - Low profile design makes it optimal for surface mounting.
 - Operating temperature -40~+125 °C
 - Quantity:500 pcs
-
- Power line noise countermeasure for various electronic equipment
 - Noise countermeasure for adapter lines and battery lines or larger electronic equipment such as note PCs and word processors

Dimensions: [mm]

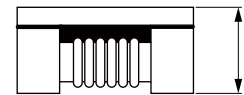
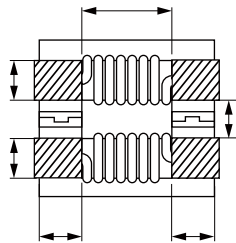
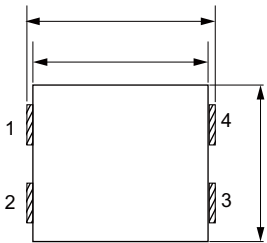

Schematic:

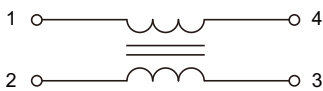

Land Pattern:[mm]

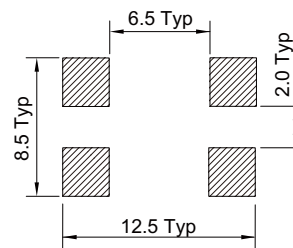

Electrical Properties:

	(Ω)	(Ω)	(m Ω)			(M Ω)



	(Ω)	(Ω)	(m Ω)			(M Ω)

Typical Electrical Characteristics:

