

MDTA Series

Flat Wire Molded Inductor

Size 1010

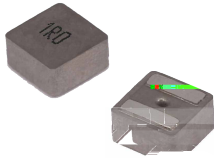

FEATURES

- Flat wire coil for low copper losses
- Composite core material allows high saturation currents
- Very low acoustic noise and very low leakage flux noise
- High current capability and handles high transient current spikes
- AEC-Q200 qualified
- Operating temperature -55 to +155°C (Including self-temperature rise)
- Quantity: 300pcs

APPLICATION

- DC/DC converters for entertainment/navigation systems
- Noise suppression for motors: windshield wipers / power seats / power mirrors / heating and ventilation blowers / HID lighting
- LED drivers

Dimensions: [mm]

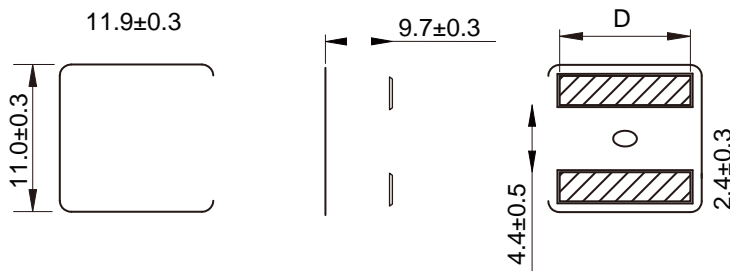

Land Pattern: [mm]

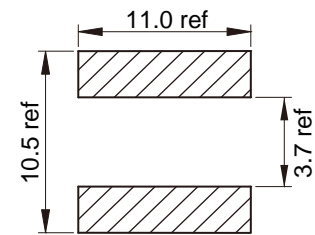

Electrical Properties:

Part No	L@100KHz /0.1V	Tolerance	I _{SAT} Typ.	I _R		R _{DC} Max.	D
				20°C rise	40°C rise		
MDTA1010-2R2M	2.20	±20%	34.0	24.5	32.0	2.80	9.3±0.5
MDTA1010-3R3M	3.30	±20%	27.4	18.2	25.0	4.10	9.3±0.5
MDTA1010-4R7M	4.70	±20%	25.4	17.5	24.0	5.70	9.3±0.5
MDTA1010-5R6M	5.60	±20%	23.6	15.7	21.2	7.20	9.3±0.5
MDTA1010-6R8M	6.80	±20%	21.8	14.0	18.5	8.90	9.0±0.5
MDTA1010-8R2M	8.20	±20%	18.3	12.9	17.1	12.4	9.0±0.5
MDTA1010-100M	10.0	±20%	17.5	11.5	15.5	13.75	9.0±0.5
MDTA1010-150M	15.0	±20%	15.5	9.9	13.8	19.30	9.0±0.5

Saturation Current will cause L to drop approximately 30%
 Temperature Rise Current that causes the specified temperature rise from 25°C ambient.

Soldering Reflow:

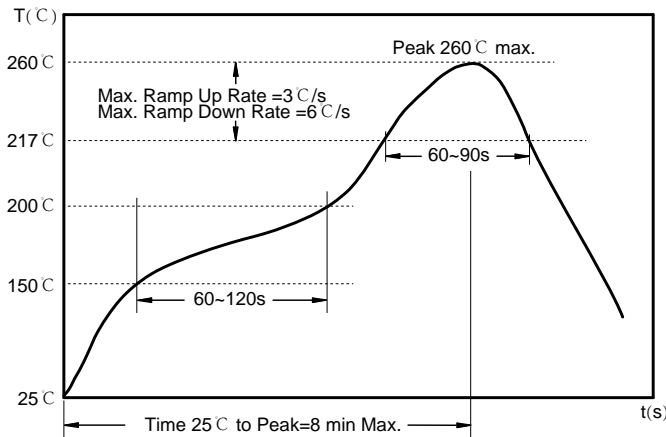

Preheat condition: 150 ~200 °C / 60~120 sec.

Allowed time above 217 °C : 60~90 sec.

Max temperature: 260 °C .

Max time at max temperature: 10 sec.

Allowed Reflow time: 2x max.

Packaging Information:

Tape Dimension :

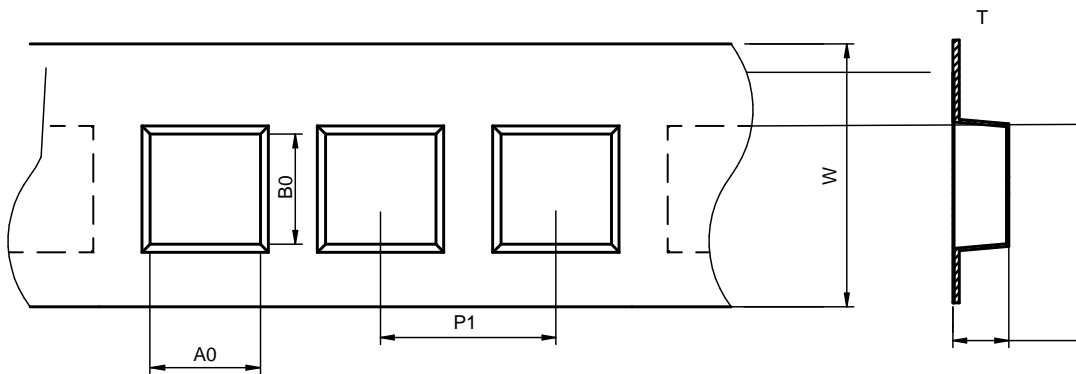

Series	A0 (mm)	B0 (mm)	D (mm)	P0 (mm)	P1 (mm)	W (mm)	K0 (mm)	E (mm)	T (mm)
MDTA1010	12.4±0.1	11.5±0.1	1.5±0.1	4.0±0.1	16.0±0.1	24.0±0.3	10.3±0.1	1.75±0.1	0.50±0.05

Peel force of top cover tape:

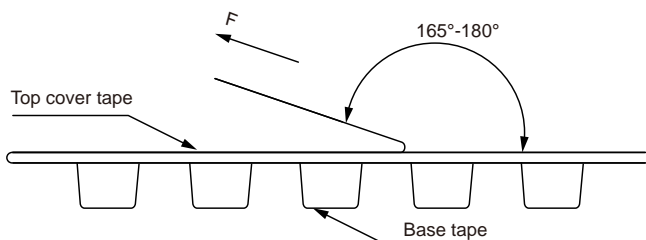

The peel force of top cover tape shall be between 0.1 to 1.3 N

Product Marking:

Marking	Printing (Inductance)
---------	-----------------------

Reel Dimension: [mm]



Packaging Quantity: